



---

*2011 Annual Conference*



# **BUILDING BRIDGES**

Meeting the Expectations of a New Generation

*November 15-17, 2011  
Gaylord National Harbor  
Hotel & Conference Center  
National Harbor, MD*



November 15, 2011

Dear Friends,

Welcome to NACDD's Annual Conference: *Building Bridges: Meeting the Expectations of a New Generation*.

This year's Conference theme and program underscore the demand to advance integrated employment opportunities for people with disabilities and related issues such as transition from school to work or college. The program includes a mix of keynote addresses, panel discussions and breakout sessions that feature a wide array of experts, including leaders from the federal government, state Councils and other agencies, and the private sector. Indeed, it is going to take the concerted, coordinated effort of leaders from all walks of life to successfully meet the expectations of a new generation. We hope all participants will benefit from this opportunity to learn, share ideas and resources, and network with friends and colleagues. In short, we hope this conference will help inspire your work back home.

We're grateful to the NACDD Member Services Committee who planned and organized this year's Conference, along with NACDD staff. Most of all, we want to thank *you* for taking the time and effort to join us this week. Together, we will build bridges to better meet the expectations of a new generation.

Best wishes,

Wanda Willis  
President  
NACDD

Anna Lobosco  
Chair, NACDD Member  
Services Committee

Michael Brogioli  
Executive Director  
NACDD

# *Building Bridges: Meeting the Expectations of a New Generation*

## NACDD Annual Conference

### **Tuesday, November 15, 2011**

---

- 1:00 – 3:30 PM     **Conference Registration**  
*National Harbor 1-3 Foyer*
- 1:00 – 3:00 PM     **NACDD Board of Directors Meeting**  
*National Harbor 15*
- 4:00 – 5:30 PM     **NACDD Membership Meeting**  
*National Harbor 2/3*
- 6:00 – 8:00 PM     **Welcome Reception with Silent Auction**  
*National Harbor Main Foyer*  
Enjoy a fun-filled evening with conference attendees as Councils showcase auction items from their home States and Territories. A great way to pick up unique holiday gifts while supporting NACDD.
- 6:00 – 8:00 PM     **Exhibit Hall**  
*National Harbor Main Foyer*

### **Wednesday, November 16, 2011**

---

- 8:00 AM – 2:00 PM   **Conference Registration**  
*National Harbor 1-3 Foyer*
- 8:00 – 8:30 AM     **Continental Breakfast**  
*National Harbor Main Foyer*
- 8:00 AM - 3:00 PM   **Exhibit Hall**  
*National Harbor Main Foyer*

**Wednesday, November 16, 2011**

---

8:30 – 10:00 AM     **Welcome and Plenary**  
*National Harbor 2/3*

**Wanda Willis**, President, NACDD  
**Anna Lobosco**, Chair, NACDD Member Services Committee  
**Michael Brogioli**, Executive Director, NACDD

***Meeting the Expectations of a New Generation: Our Success Stories***  
Self-advocates will provide reflections of transition from school to work and higher education. This session will highlight how people with developmental disabilities have transitioned successfully and what lessons have been learned.

**Mat McCullough**, Executive Director, District of Columbia Development Disabilities Council  
**Liz Weintraub**, Self-advocacy Project Specialist, Association of University Centers on Disabilities  
**Brett Cunningham**, College Student, Oklahoma Developmental Disabilities Council member, NACDD Board member  
**Ricardo Thornton**, Library Technician, Martin Luther King, Jr. Memorial Library

10:00 – 10:15 AM     **Beverage Break**  
*National Harbor Main Foyer*

10:15 – 11:30 AM     **Concurrent Sessions**

***Criminal Justice Systems and Individuals with Developmental Disabilities: Building Bridges from First Contact to Community Re-entry***  
*National Harbor 4*

Panelists will present findings from recent research to discuss the status of people with developmental disabilities in juvenile and adult criminal justice systems as well as discuss service system supports for individuals with developmental disabilities, as they move from institutional settings to community life.

**Jane Dunham**, Sub-Committee Chair, New Jersey State Advisory Committee to the U.S. Commission on Civil Rights and Project Manager/Diversity Coordinator, New Jersey Council on Developmental Disabilities  
**Jessica S. Oppenheim**, Esq., Director of the Developmentally Disabled Offenders Program, Arc of New Jersey  
**Beverly Frantz**, PhD, Director, National Academy for Equal Justice for People with Developmental Disabilities at the Institute on Disabilities at Temple University

**Wednesday, November 16, 2011**

---

10:15 – 11:30 AM **Concurrent Sessions** *CONTINUED*

***Paths to Employment: Project SEARCH and Think College NY!***

*National Harbor 5*

This session highlights two on-the-ground projects, funded by the New York State Developmental Disabilities Planning Council and the B. Thomas Golisano Foundation, which support transition age young adults to achieve their goals of community-based, competitive employment and independent living. Participants will learn how individual initiatives with businesses and colleges were developed, in addition to a statewide initiative focusing on employment systems change.

**Martha Mock**, Ph.D., Director, Institute for Innovative Transition (IIT)

**Karen Jackuback**, M.A., Program Planner, New York State Developmental Disabilities Planning Council

***Advocating with Elected Officials***

*National Harbor 6*

Presenters will share information that builds the bridge “to be heard” through the use of a plain language process designed to increase civic engagement including effective ways to communicate with elected officials. Each session attendee will be provided a set of tools and training materials.

**Carol Risley**, Executive Director, California State Council on Developmental Disabilities

**Mark Starford**, Director, Board Resource Center

***The Convention on the Rights of Persons with Disabilities and YOU!***

*National Harbor 7*

This interactive session will offer participants an understanding of the Convention on the Rights of People with Disabilities. Session attendees will learn how to take a human rights-based approach to disability issues.

**David Morrissey**, Executive Director, U.S. International Council on Disabilities

11:30 – 11:45 AM **Break**

11:45 AM– 1:15 PM **Plenary Luncheon**  
*National Harbor 2/3*

***What Happens When the Bus Stops Coming? Thoughts on Making Transition from School to Work WORK!***

**Connie Garner**, Policy Director, Foley-Hoag, Executive Director for Advance CLASS, Inc., former Senior Advisor to Senator Edward M. Kennedy and Policy Director, Disability and Special Populations, to the U.S. Senate Committee on Health, Education, Labor and Pensions Committee (HELP)

**Wednesday, November 16, 2011**

---

1:15 – 1:30 PM      **Break**

1:30 – 2:45 PM      **Concurrent Sessions**

***Working with People in Prison***

*National Harbor 4*

This session will provide a step-by-step overview of a systems change effort that successfully impacted the design and implementation of services for inmates with developmental disabilities within the New York State Department of Correctional Services. Participants will learn how using the process of person-centered planning leads to changes in the attitudes and behavior of facility personnel and inmates in medium and maximum level prison settings.

**Thomas P. Golden**, CRC, Associate Director, Employment and Disability Institute  
Cornell University, School of Industrial and Labor Relations

**Carol Blessing**, LMSW, Project Director, Employment and Disability Institute at  
Cornell University's School of Industrial and Labor Relations

***Self Advocacy, the Community and Friends that Helped Us Get Here***

*National Harbor 5*

Participants will learn the value and importance of investing in self advocacy; the distinctions between inclusion and meaningful participation and the importance of collaboration and creating relationships in the community as well as with the DD Network and other stakeholders.

**Larry Fries**, Chairperson, Past President, Idaho Self-Advocate Leadership Network

**Christine Pisani**, Program Specialist, Idaho Council on Developmental Disabilities

***Changing Our Mindset and Infrastructure: Innovative Strategies to Promote Effective and Efficient Services***

*National Harbor 6*

This session features strategies to engage and empower community partners to work together effectively and efficiently, including a common set of principles and standards, community based consortiums and communities of practice. Project models are replicable and participants will gain valuable insights to develop the philosophy, knowledge and critical skills to achieve natural, sustainable collaborations.

**Kathryn Cappella**, Executive Director, New York State Disabilities Advocacy  
Association and Network

2:45 – 3:00 PM      **Beverage Break**

*National Harbor Main Foyer*

3:00 – 4:15 PM

**Concurrent Sessions**

***Supports to Allow Greater Inclusion on College Campuses***

*National Harbor 4*

*Next Steps* at Vanderbilt University has developed a model of circles of support for students with intellectual disabilities across the range of activities and environments at college. With proper supports, students are gaining the skills and experiences needed for more meaningful employment and independent living. Session participants will gain knowledge on how volunteer students' peers can successfully support students with intellectual disabilities; how students can find personal success learning skills at a technology training center and how colleges and universities can work collaboratively to develop postsecondary experiences for students with intellectual disabilities.

**Tammy Day**, M. Ed., Next Steps Program Director

**Elise McMillan**, J.D., Next Steps Faculty Co-Director

**Alicia Cone**, Tennessee Council on Developmental Disabilities

**Edward Nesbitt**, Current Student, Next Steps

***A New Generation of Leaders: Michigan Partners for Freedom***

*National Harbor 5*

Session attendees will learn how to build a network of people with disabilities, family members, advocates, organizations and other allies working together to build statewide demand for self-determination principles into state service systems.

**Angela Martin**, Community Support Specialist and Research Assistant,  
Developmental Disabilities Institute, Wayne State University

**Patricia Carver**, President, Community Drive, Inc.

***Effective Coalition-Building: Lessons Learned from Wisconsin's Survival Coalition***

*National Harbor 6*

This session focuses on how more than 40 disability-related groups in Wisconsin, with leadership from the State's three DD Network partners have developed an effective policy and advocacy coalition. Participants will review strategies for developing effective policy collaborations with partner agencies, structures for furthering policy agendas across broad stakeholder groups and examples of activities and products emerging from effective coalition work.

**Beth Swedeen**, Executive Director, Wisconsin Board for People with Developmental Disabilities

**Fil Clissa**, Deputy Director, Wisconsin Board for People with Developmental Disabilities

3:00 – 4:15 PM      **Concurrent Sessions** *CONTINUED*

***Generic Change: A Bridge to an Alternative Future***

*National Harbor 7*

Session attendees will learn about cultural transformation initiatives that operationalizes Council values of emphasizing generic systems change and non-deficit models of thinking about disability. Participants will experience a different approach to the redesign of systems and awareness of significant implications for addressing the stigma that is at the core of the dysfunction of our present systems.

**Jeffrey Parker**, Chairperson, Pennsylvania Developmental Disabilities Council and COO, UCP of Pittsburgh

**Graham Mulholland**, Executive Director, Pennsylvania Developmental Disabilities Council

4:15 - 4:30 PM      **Break**

4:30 – 5:45 PM      **Plenary Session**

*National Harbor 2/3*

***Here Come the Feds: Supporting Effective Transitions to Employment and Post-Secondary Education***

**Sharon Lewis**, Commissioner, Administration on Developmental Disabilities

**Lynnae Ruttledge**, Commissioner, Rehabilitation Services Administration

**Melody Musgrove**, Director, Office of Special Education Programs

**Kathy Martinez**, Assistant Secretary, Office of Disability Employment Policy

**Thursday, November 17, 2011**

---

7:30 – 8:00 AM      **Continental Breakfast**  
*National Harbor Main Foyer*

8:00– 11:45 AM    **Exhibit Hall**  
*National Harbor Main Foyer*

8:00 – 9:00 AM      **Opening Plenary**  
*National Harbor 2/3*

***Perspectives from the Field: What's Happening with Employment in the Corporate Sector?***

This facilitated discussion panel will provide perspectives from the business world, disability employment researchers, and a DD Council on employment trends for people with intellectual and developmental disabilities in the corporate sector. Time allowing, audience members will be able to ask questions. Join us for this great start to the day!

**Jill Houghton**, Executive Director, U.S. Business Leadership Network  
**Bill Kiernan**, University of Massachusetts' Institute for Community Inclusion  
**Margaret Harkness**, Program Specialist, Illinois Council on Developmental Disabilities  
**Ann Cameron Caldwell, PhD**, Chief Research and Innovations Officer, The Arc

9:05 – 10:15 AM    **Concurrent Sessions**

***A Peak at Reap What You Sow: Harvesting Support Systems – A New Self-Determination Training for Youth and Family***

*National Harbor 4*

This session provides an overview and demonstration of original, hands-on activities that are utilized to guide youth and their allies to build systems of support that enable youth with disabilities to reach their goals.

**Stacey Milbern**, National Youth Leadership Network, Community Outreach Director  
**Jayne Chase**, Adult Ally

***Grassroots Advocacy and Self-Advocates: Working Together to Create a Better Community***

*National Harbor 5*

This session illustrates the Utah experience in building a bridge between a state-wide regional advocacy group and People First Chapters. Session attendees will learn practical ideas on leadership development, advocacy, community awareness and fiscal sustainability.

**Mandy L. Shale**, Executive Director, Family Advocacy and Consultation Services  
**Brooke Wilson**, Outreach Coordinator, Family Advocacy and Consultation Services  
**James O'Neill**, Park City People First Self-Advocate  
**Frank Brown**, Park City People First Self Advocate

9:05 – 10:15 AM      **Concurrent Sessions** *CONTINUED*

***Employment Success from Underserved Populations***

*National Harbor 6*

Youth with disabilities want real jobs with real wages. Attendees will learn about progressive employment practices and trends worth watching and LEARNING from.

**Cheryl Bates-Harris**, Senior Advocacy Specialist, National Disability Rights Network  
**Laura Owens**, Executive Director, APSE

***Healthlink for Nurses: A Disability Training Curriculum***

*National Harbor 15*

This session features two important initiatives regarding health care for people with developmental disabilities. Healthlink is a multidemensial disability curriculum to educate nurses to provide health care to people with developmental disabilities. Healthlink addresses personal attitudes and assumptions of health care providers and examines the social and environmental barriers that affect the delivery of quality health care.

**Kathy Kelly**, R.N., Director, Clinical Services at UCP of New York City  
**Fran Judge**, R.N., Assistant Medical Director, UCP of New York City

***National Curriculum in Adult Developmental Medicine***

*Part 2--National Harbor 15*

The second important initiative in healthcare for people with developmental disabilities highlights work on the pilot curriculum designed to improve person-centered health care for individuals with intellectual and developmental disabilities.

**Matthew Holder**, MD, MBA American Academy of Developmental Medicine and Dentistry

**Laurence Bauer**, M.Ed., Executive Director, Family Medicine Education Consortium

**Irene Jurczyk**, BBA, Associate Director, Mountain Area Health Education Center  
Self Advocate(s) and Parent(s) from North Carolina Council on Developmental Disabilities

10:20–11:30 AM      **Concurrent Sessions**

***Moving Beyond Tokenism: Self Advocates Serving as Full Participants on Leadership Bodies***

*National Harbor 4*

Panelists will present their experiences serving on boards, the barriers encountered and best practices which lead to success. Research findings and actions that disability organizations can implement to fully include self-advocates being active and contributing members of their boards and policy making bodies will be presented.

**Steve Dorsey**, Trainer and Developer, Beyond Tokenism Training Program  
**Bill Krebs**, Trainer and Developer, Beyond Tokenism Training Program  
**Lynette Savoy**, Trainer and Developer, Beyond Tokenism Training Program  
**Mark Friedman**, Director, Beyond Tokenism Project  
**Marian Frattarola-Savilino**, Director, Values into Action

***Ending Segregated and Sheltered Employment***

*National Harbor 5*

Segregation in employment was considered a way to allow people with disabilities to prepare to be employed in a job outside the confines of large segregated employment environments. The problem is that, for most individuals, segregated employment environments (including Work Centers) are the “end” instead of the means to productive employment. Learn how segregated employment came into being and how these environments continue to operate. In addition, hear what advocacy strategies exist to end this practice and instead promote full inclusion and full employment of all individuals with disabilities.

**Cheryl Bates-Harris**, Senior Advocacy Specialist, National Disability Rights Network  
**Eve Hill**, Department of Justice

***Siblings of People with Disabilities: The Next Generation of Supporters***

*National Harbor 6*

Session attendees will learn about the unique opportunities and concerns of siblings of people with disabilities and how siblings are partnering with self-advocates. Participants will learn about research and resources for siblings and ways to build support for them.

**Katie Arnold**, M.S., Executive Committee Member, Sibling Leadership Network  
**John Kramer**, Ph.D., Chairperson, Sibling Leadership Network  
**Don Meyer**, M.Ed., Director, Sibling Support Project

Thursday, November 17, 2011

---

10:20–11:30 AM      **Concurrent Sessions** CONTINUED

***Building Public and Political Will for System Change: Challenging New Jersey's Dependence on Seven Large State-run Residential Centers***  
*National Harbor 15*

Attendees will learn how to build public support for closing institutions and how to challenge opposition from families and labor unions. Presenters will discuss how self-advocates in local community-based organizations can change the public perception of people with developmental disabilities and how to mobilize people in the DD community to facilitate change and support self-advocates and family members taking leadership roles.

**Jane Dunham**, Project Manager/Diversity Coordinator, New Jersey Council on Developmental Disabilities

**Elaine Buchsbaum**, Chair, New Jersey Council on Developmental Disabilities

**Todd Emmons**, Member, New Jersey Council on Developmental Disabilities/Co-Facilitator, Camden County Monday Morning Network

**Alison Lozano**, Ph.D., M.P.A., Executive Director, New Jersey Council on Developmental Disabilities

11:45 AM-1:00 PM      **Champions of Equal Opportunity Luncheon**  
*National Harbor 2/3*

**Guest Speaker:**      **Aaron Bishop**, Executive Director, National Council on Disability

**Honorees:**              **U.S. Rep. Rosa DeLauro**, D-CT  
                                 **Kelly Holt**, Self-advocate, Utah

# Speakers and Presenters

**Katie Arnold** is an Executive Committee member of the national Sibling Leadership Network (SLN) and serves as the Vice President of the Illinois State sibling chapter, SIBS (Supporting Illinois Brothers and Sisters). Katie is the Director of Community Education in the Institute on Disability and Human Development (IDHD) at the University of Illinois at Chicago (UIC). She holds a Masters Degree in Disability and Human Development from the University of Illinois at Chicago and received the 2009 UIC Humanitarian of the Year award for her dedication to the advancement of human rights of people with disabilities as well as the 2011 Chicago Young Nonprofit Professional of the Year. Katie's passion about her work with people with disabilities stems from her experience growing up with her sister with developmental disabilities.

**Cheryl Bates-Harris** is a Senior Disability Advocacy Specialist for National Disability Rights Network in Washington, DC. She currently provides technical assistance and training to the Protection and Advocacy/Client Assistance Programs nationwide. Cheryl has in-depth knowledge of cross disability issues and continues to focus on employment issues of people with disabilities, including Vocational Rehabilitation, Social Security Return to Work, TANF, DOL One Stops , sheltered workshops and other employment programs that impact people with disabilities. She was responsible for the development of the SSA Protection and Advocacy Dispute Resolution Project and later the development of the Protection and Advocacy for Beneficiaries of Social Security (PABSS). Since the passage of Ticket to Work and Work Incentive Improvement Act, Cheryl has conducted national training on TWWIIA and Vocational Rehabilitation Services and is considered a leading expert on the intersection issues of the Ticket to Work with state vocational rehab services.

**Laurence Bauer, M.Ed.**, is the Executive Director of the Family Medicine Education Consortium (FMEC). The FMEC is a not-for-profit organization which supports the educational and scholarly needs of family physicians. Among its goals are the development of programs and services that promote leadership skills for its current and future family medicine leaders. It has provided annual conferences on improving primary care for persons with developmental disabilities since 2003.

**Aaron Bishop** joined the NCD staff in November 2010 as its Executive Director. He came to NCD with nearly 20 years of experience working with and for individuals with disabilities in both the service provision and public policy sectors. Prior to assuming his role at NCD, he was a Professional Staff Member for the U.S. Senate Health, Education, Labor and Pensions (HELP) Committee for Senator Mike Enzi, where he handled disability related policy. Mr. Bishop also worked for Senator Judd Gregg on the HELP Committee, when the Senator chaired the committee. Mr. Bishop began his work on Capitol Hill through a Kennedy Foundation Public Policy Fellowship to specifically work on federal disability policy and legislation. Mr. Bishop's other professional experiences have included work for the Association of University Centers on Disabilities, the Waisman Center University Center for Excellence in Developmental Disabilities, and the Mental Health Center of Dane County. Mr. Bishop received his Master's of Science in Social Work degree, with an emphasis in public policy, and two Bachelor of Science in Natural Sciences degrees from the University of Wisconsin-Madison.

**Michael Brogioli** is the Executive Director of the National Association of Councils on Developmental Disabilities (NACDD) and serves on the Alliance for Full Participation (AFP) Board

of Directors. He has over 20 years of experience working in leadership positions in the nonprofit sector on health and human services issues, including as the Vice President for Policy and Government Relations at Special Olympics International, Executive Director of the Autism Coalition for Research and Education, and Director of the Welfare Reform Project at Catholic Charities USA. He was a Jacob Javits Fellow and legislative assistant on health care reform to U.S. Senator Tom Daschle in 1993-94. He holds a Master of Public Policy degree from Duke University and a Bachelor's degree in Government and International Relations from the University of Notre Dame. A native of Massachusetts, Brogioli lives and works in Washington, DC.

**Carol Blessing**, LMSW, has spent over 25 years of professional service on the faculty with Cornell University's Employment and Disability Institute within the School of Industrial and Labor Relations. As a faculty member, she currently serves as Project Director for the New York State Office of Mental Health Career Development Initiative, a project working within New York State psychiatric centers what was designed to enhance the systemic ability to facilitate community employment and individualized recovery-oriented services with people who have been diagnosed with a mental illness. Carol directed the Inmate to Citizen research demonstration system impact project from 2003 – 2008, an initiative that focused on integrating person-centered practices into the assessment, design and implementation of services for inmates with special needs in the New York State correctional system.

**Elaine Buchsbaum** is the Chairperson of the New Jersey Council on Developmental Disabilities. She has extensive experience in family support coordination and additionally served as a Resource Parent Trainer in special education for the Statewide Parent Advocacy Network of New Jersey. Elaine has provided leadership for a variety of disability advocacy organizations including serving on the Board of Directors of Autism New Jersey and The Arc of New Jersey and has served on her local board of education for 15 years. She earned her Master's degree in Library Science from Simmons College, Graduate School of Library Science and served as a librarian in various settings. Mrs. Buchsbaum is the mother of an adult son with autism and intellectual disabilities who is successfully employed in integrated settings.

**Ann Cameron Caldwell, Ph.D.**, in her current role of Chief Research and Innovations Officer at The Arc, advances the mission and goals of The Arc through implementing progressive initiatives and projects on a national scale. She is responsible for leading resource development in private and federal arenas, as well as the internal organizational research activities that advance mission and raise internal use of innovation, best practices, and evidence-based interventions within the chapters of The Arc network. She is a Stanford University Fellow, Graduate School of Business, Center for Social Innovation (2011) and is faculty at the Department of Disability and Human Development at the University of Illinois at Chicago. Earlier professional roles included working in the disabilities field in development and as a consultant. Dr. Caldwell received her master's degree from the University of Chicago in Liberal Arts and her doctorate in Disability Studies from the University of Illinois at Chicago in 2005. She is mother to Geoffrey, a teenager living with Down syndrome.

**Kathryn Cappella** is the Executive Director of the New York State Disabilities Advocacy Association and Network (NYS DAAN), a cross-disability statewide resource network launched with funding from the New York State Developmental Disabilities Planning Council. Kathryn has been both a front-line advocate for children and adults with developmental disabilities for more than 30 years, and systems advocate promoting positive changes in community integration in the areas of

education, employment, recreation, housing, and health care. She earned her BA in Psychology and minor in Black Studies from the University of Rochester, NY with coursework at Howard University in Washington, D.C. Ms. Cappella has been an administrator in the non-profit sector for more than 30 years, and has been a successful private sector custom homebuilder for more than 20 years. She is an Aging in Place Specialist, an Americans with Disabilities Act (ADA) trainer, and a Benefits and Workforce Incentives/Ticket to Work Specialist; she also serves on the Board of the Learning Disabilities Association of NYS, Advisory Boards for the TRIO Programs for the Rochester Institute of Technology, and SUNY Genesee Community College in upstate New York. Additionally, Katherine; is an active member of the IDEA Partnership NYS Community of Practice.

**Patricia Carver** is the Communications Coordinator for Michigan Partners for Freedom and is President of Community Drive, Inc., a knowledge based practice dedicated to helping people build community – large and small - through respect and relationships. Pat's past achievements include heading the communications efforts for Center for Self-Determination, coordinating the 2008 International Conference on Self-Determination, and developing the Michigan Academy on Self-Determination. Ms. Carver is an advocate for social justice, especially amid citizens who experience cognitive or intellectual disabilities which began over four decades ago at the birth of her brother and the subsequent recognition that his being "special" meant being "set apart."

**Jayne Chase** is the mother of 3 children: Christina, Todd, and J. Paul. She became involved in disability issues when J. Paul received the label of autism. Jayne's past achievements include coordinating the Partners in Policymaking™ of Alabama program; contributing to grants relating to employment and assistive technology in Alabama. She worked with Auburn University to create a distance learning course for teachers who work with students with disabilities and has been the recipient of many awards including Mentor of the Year by the Alabama Early Intervention and Preschool Agency as well as a Lifetime Achievement Award by the Alabama Disabilities Protection and Advocacy Program.

**Fil Clissa** is currently the Deputy Director of the Wisconsin Board for People with Developmental Disabilities. Her work has been focused on providing greater opportunities for people with disabilities to participate in community life. She is also the administrative staff for the Survival Coalition.

**Alicia Cone, PhD** has worked in the field of developmental disabilities for over twenty (20) years, in the states of Mississippi, Virginia, and Tennessee primarily in grants management and supported employment, with additional work in sheltered work, residential services, and case management. Dr. Cone taught at the University of Mississippi, and conducted research into disability policy and practice at Virginia Commonwealth University's Rehabilitation Research and Training Center on Workplace Supports (formerly RRTC on Supported Employment). She was previously the Director of Independent Support Coordination for the Tennessee Department of Intellectual and Developmental Disabilities.

**Brett Cunningham** is a 23 year old college student attending The University of Central Oklahoma majoring in Special Education. In his first year of high school, Brett entered Tech Now, a program for high school students with disabilities to encourage career planning and post-secondary education, and participated in this program all four years of high school. In the spring of 2005, his sophomore year, he applied to the Oklahoma Youth Leadership Forum (YLF) for people with disabilities. Since the summer 2005, Brett has returned to YLF each summer to be a mentor/facilitator. Mr. Cunningham graduated from Southeast High in Oklahoma City, Ok in 2006

and was awarded a scholarship from the Dream Institute to pursue a degree in Special Education. In the fall of 2007, Brett entered Partners in Policymaking™, an advocacy training program for adults with disabilities which teaches people to be advocates for young children with disabilities. During this time Brett was appointed to the National Council on Disability Youth Advisory Committee. Mr. Cunningham has twice been appointed to state boards by Oklahoma Governor Brad Henry. He serves on the Oklahoma Developmental Disabilities Council and the Governor's Advisory Committee to the Office of Disability Concerns. In the fall of 2010, he was also elected to the Board of Directors for the National Association of Councils on Developmental Disabilities.

**Tammy Day, M. Ed.** is the Program Director of Next Steps at Vanderbilt. She joined Vanderbilt in 2009, and the first group of 6 students began their studies on campus in January 2010. Her previous experience includes time as a Special Education High School Liaison/Compliance Specialist, Rutherford County Schools, a Statewide Work-Based Learning Trainer for the Tennessee State Department of Education, and as a Special Education Teacher, grades 7-12, in Rutherford County Schools. At Vanderbilt University, she has overseen the development of the academic, social and employment areas of the Next Steps program.

**Rosa DeLauro (D-CT)** is the Congresswoman from Connecticut's Third District that stretches from the Long Island Sound and New Haven to the Naugatuck Valley and Waterbury. Rosa serves in the Democratic leadership as co-chair of the Steering and Policy Committee, and is the ranking member on the Labor, Health, Human Services, and Education Appropriations Subcommittee, where she oversees our country's investments in education, health, and employment. She also serves on the subcommittee responsible for FDA and agriculture, where she oversees drug and food safety. For Rosa, her work has been and will always be about helping people. That is why Congresswoman DeLauro believes our first priority must be to strengthen our economy and create good middle class jobs. She supports tax cuts for working and middle class families, fought to expand the Child Tax Credit to provide tax relief to millions of families, and introduced legislation to help grow our economy by making smart innovative investments in our infrastructure and helping manufacturing businesses to succeed. As the ranking member dealing with appropriations for Labor, Health, Human Services, and Education, Rosa is determined to increase support for education and innovation, to fully implement the new health care reform law, to protect the rights of employees and unions, and raise living standards. Rosa has led the fight in Congress to achieve full pay equity for women and to ensure that all employees have access to paid sick days. Rosa believes that we have a moral obligation to our nation's veterans and their families, and her concern for these heroes extends to both their physical and mental well-being. Rosa supports a transformation in how the Department of Veterans Affairs is funded, including advanced appropriations for health services, to ensure its fiscal soundness; and she successfully championed legislation to guarantee that troops deploying to combat theaters get the mental health screening they need both before and after deployment, as well as championed legislation that now provides assistance to today's Post-9/11 veterans choosing to pursue on-the-job training and apprenticeship programs. Soon after earning degrees from Marymount College and Columbia University, Rosa followed her parents' footsteps into public service, serving as the first Executive Director of EMILY'S List, a national organization dedicated to increasing the number of women in elected office, Executive Director of Countdown '87, the national campaign that successfully stopped U.S. military aid to the Nicaraguan Contras, and as Chief of Staff to U.S. Senator Christopher Dodd. In 1990, Rosa was elected to the House of Representatives, and she has served as the Congresswoman from Connecticut's 3rd District since. Rosa is married to Stanley Greenberg, President of Greenberg Quinlan Rosner, a public issues

research firm. Their children—Anna, Kathryn and Jonathan Greenberg—all are grown and pursuing careers. They have four grandchildren, Rigby, Teo, Sadie, and Jasper.

**Steve Dorsey** is currently the Treasurer and Board Member of the newly formed Self Advocates United as 1. He is a former member of the Adult Services Committee of the Pennsylvania Developmental Disabilities Council, a past Board member of the State Independent Living Council and a founder and former President of Speaking For Ourselves.

**Jane Dunham** is the Project Manager and Diversity Coordinator for the New Jersey Council on Developmental Disabilities (NJCDD) and has over 15 years experience with the Council. Her experience in disability related fields spans 40 years and is a nationally recognized speaker. For the past decade, Ms. Dunham's work has included issues relating to race and disability. She is a founding member and former Chair of the National Black Disability Coalition. Ms. Dunham is a member of the NJ State Advisory Committee to the U.S. Commission on Civil Rights and recently served as the Sub-Committee Chair of a hearing about ADA accommodations for inmates with non-apparent disabilities in the New Jersey Department of Corrections. Ms. Dunham has also served in a professional capacity for numerous national organizations including the U.S. Women's Bureau, the Employment and Training Administration of the U.S. Department of Labor, Disability Rights California and United Cerebral Palsy Association. In 2009, Ms. Dunham received the Exemplary Practice Award from the New Jersey Human Relations Council. Ms. Dunham is the mother of an adult daughter who has a developmental disability. Her daughter has a Masters degree and lives independently in Washington, DC.

**Todd Emmons** is a member of the New Jersey Council on Developmental Disabilities (NJCDD) and is Co-Facilitator of the Camden County Monday Morning Network, a self-advocacy organization. Mr. Emmons is an experienced leader who frequently testifies and advocates about community supports and civil rights and provides meaningful insights about his personal experiences transitioning from large institutions to independent life in the community. He works with institutional residents as part of the Seeking Ways Out Together (SWOT) Team, an advocacy group that facilitates and prepares people for successful transition to the community. Mr. Emmons is a graduate of the New Jersey Council on Developmental Disabilities (NJCDD) Partners in Policymaking™ leadership training program and a recipient of the Colleen Frasier Award for outstanding self-advocacy at the 2011 NJCDD Community Building Awards.

**Beverly Frantz, PhD**, is the coordinator for Criminal Justice and Sexual Health programs and the National Academy for Equal Justice for People with Developmental Disabilities at the Institute on Disabilities at Temple University. She oversees the development of personal safety, criminal justice and sexual health training curricula for people with developmental disabilities and professionals, and provides training and technical assistance to criminal justice professionals, victims, and disability organizations and educators. She has well published and has been the Principle Investigator on several research projects exploring the unique challenges and disadvantages individuals with intellectual and developmental disabilities face in the criminal justice systems. Dr. Frantz has extensive experience in victim and disability advocacy; is co-founder of A Woman's Place, a domestic violence program and shelter, served on the faculty of the Pennsylvania Victim Assistance Academy, and was a Vera Institute of Justice Associate. Dr. Frantz has developed successful partnerships between self-advocacy, disability and victim assistance organizations and is currently working with OVC/TTAC on developing three day training for crime victim professionals on responding to crime victims with disabilities. She lectures at Arcadia, West Chester, and Temple Universities and is a recognized state and national speaker.

**Marian Frattarola-Saulino** is a co-founder and executive director of Values into Action, an organization that supports people with disabilities in their own homes and communities. The organization works in partnership with people, their families and other allies to build personal support systems that people themselves control and direct. She has worked as a support broker and support services worker as well as helped people and their families develop and operate their own micro boards.

**Mark Friedman, Ph.D.** is the Director of the Beyond Tokenism project. He is currently to the Go Team of New Jersey, the Tennessee Micro board Association and the Digital Equality Center. Dr. Friedman was a National Advisor to the founding board of Self-Advocates Becoming Empowered and is the former Executive Director of the Middle Tennessee Advocacy Center. He was the founding State Coordinator of Speaking for Ourselves. Mark helped support the development of more than 100 nonprofit disability organizations in five states and was, formerly, the Vice Chairperson of the Pennsylvania Developmental Disabilities Council. He has a Ph.D. degree in Organizational Leadership from Union Institute and University.

**Larry Fries** is a member of the Idaho Self Advocate Leadership Network (SALN) since 2005 and served as the President of the SALN state board from 2009-2011. Mr. Fries graduated from the Idaho Partners in Policymaking™ program in 2005 where he learned that anybody can be self-determined with the right supports. Larry was adopted when he was two years old into a great family. It's been a fun ride being a part of it and he wouldn't change anything for the family he has. Larry takes every day as a new day with a new challenge, a new goal, and with a positive attitude.

**Connie Garner** focuses her practice as Policy Director in the Government Strategies Practice Group, Foley Hoag and is Executive Director for Advance CLASS, Inc. Her areas of expertise include health care, disability, long-term care, and education. Before joining Foley Hoag, Connie was Policy Director, Disability and Special Populations, to the U.S. Senate Committee on Health, Education, Labor and Pensions Committee (HELP) for 17 years, where she has served Chairman Harkin, Senator Dodd, and the late Senator Kennedy. In that role, Connie was the lead Democratic Committee architect for the CLASS Act, the major long-term care legislation that is part of health care reform; enactment of the landmark Mental Health Parity Act 2008; the 2006 and 2009 reauthorizations of the \$2 billion Ryan White CARE Act; the Family Opportunity Act of 2006 and the 2005 reauthorization of Individuals with Disabilities Education Act (IDEA), the Special Education Law; and the 1999 Ticket to Work and Work Incentives Improvement Act. Connie also served in the U.S. Department of Education, as Director of the Federal Interagency Coordinating Council for Children with Disabilities and the Secretary of Education's principal liaison on all interagency health care matters, including health care reform. Prior to her work with the Federal government, Garner provided clinical nurse specialist services in both urban and rural public health settings as well as inpatient hospital settings, and managed several large maternal-child health inpatient hospital units in both Philadelphia and the Washington-DC area. Dr. Garner has a B.S. in Nursing (University of Pennsylvania, 1979) and M.S. in Nursing (George Mason University, 1982), an Ed. S. in Special Education (George Washington University, 2000), and her Doctoral work is in both Health and Education Public Policy (George Washington University, 2001); she is also certified as a Pediatric and Neonatal Nurse Practitioner.

**Thomas P. Golden, M.S., C.R.C.** is the Associate Director of the Employment and Disability Institute (EDI) in the Industry and Labor Relations School at Cornell University. He has been on faculty since

1991 focusing primarily on: social insurance policy and its relation to return to work and greater economic independence and self-sufficiency for individuals with disabilities who receive public benefits and entitlements; national and global disability and employment their communities; and, organizational development, transformation and systems change with an emphasis on facilitating diverse and inclusive communities.

**Margaret Harkness** is a Program Specialist with the Illinois Council on Developmental Disabilities. A main focus for the Council has been employment and the pursuit of change at the systems level, Margaret participated in the 3 year Chicago Mayoral Taskforce on Employment for Persons with Disabilities which led to the establishment of Disabilityworks and the Chicagoland Provider Leadership Network. Currently, she is involved with the Governor's Employment and Economic Opportunity Taskforce in planning an Employment First Summit in an attempt to bring consensus to utilizing the state's very limited resources for integrated employment. Through her participation on many workgroups, taskforces, and partnerships, Ms. Harkness has helped drive Illinois in changing its dialogue from sheltered employment to supported, community employment. Margaret graduated from Valparaiso University with a B.S. in Psychology, and continued by obtaining an M.A. in Applied Behavior Analysis at Western Michigan University. There she worked in a school with children who had multiple disabilities. Margaret's first career was to provide behavior analysis services in-home to families and at schools and community based programs. In that capacity, she got to know the myriad communities and ethnic groups within Chicago.

**Matthew Holder**, MD, MBA, is the executive director of the American Academy of Developmental Medicine and Dentistry (AADMD). The AADMD was formed in 2002 to advance the medical and dental care of persons with intellectual and developmental disabilities.

**Kelly Holt** was born with an intellectual disability resulting from complications at birth. Her mother and family encouraged her to do her best and she picked up the family sense of humor and love of pranks. Kelly grew up in California and worked in catering prior to her family's relocation to the small town of Price in eastern Utah. As a caterer, Kelly got to meet Bob Hope, the senior President Bush and many other celebrities. When Kelly moved to Utah over ten years ago, she became active in the self-advocacy movement and went onto the Waiting List for services. Kelly came to Salt Lake (a 2-hour drive) to an advocacy meeting to meet Legislators. She grasped the big picture right away and her local legislators and Price elected officials came to know Kelly as she took up the cause "language matters." Even though Kelly has ended her terms on the Council, she stays current and has gone on to serve in other leadership capacities: Board Member of the Disability Law Center (P&A) and the Utah State Center for Persons with Disabilities (UCED's) Consumer Advisory Committee. Rather than wait for formal services, Kelly found her own job at the local Price college in order to pay her way to the national SABE conferences. After being laid off, she became self-employed selling Mary Kaye. Kelly lives with her sister and her elderly father. Kelly plays a critical role in providing caregiving for her father.

**Jill Houghton** is Deputy Director of the Southeast Technical Assistance and Continuing Education (TACE) Center. Her creative spirit and passionate approach to the inclusion of people with disabilities comes from her core. While pursuing her bachelor's degree from the University of Kansas, she interned for Senator Dole and the experience ignited the direction of her professional aspirations. Jill is currently consulting with the U.S. Business Leadership Network (USBLN), Walgreens and AMERIGROUP. She has been working with Fortune 500 companies to recruit, hire and promote employees with disabilities through building partnerships with state vocational rehabilitation agencies and employment service providers. Additionally, she is leading an effort to

develop and implement a diversity/disability supplier program. Prior to working with Fortune 500 companies, Ms. Houghton served as the Executive Director of the Ticket to Work and Work Incentives Advisory Panel from February 2005 until its legislative sunset in January 2008. The bipartisan Panel was comprised of twelve private citizens and was housed independently within the Social Security Administration in Washington D.C. The Panel's charge was to advise the President, Congress and the Commissioner of Social Security on the Ticket to Work and Self-Sufficiency Program and issues related to work incentives programs, planning and assistance for individuals with disabilities. Jill brings over 18 years of diverse work experience on behalf of people with disabilities from the federal, state and local level. Her career has included building relationships with employers while at the Florida Division of Vocational Rehabilitation, working with employers to found the Washington State Business Leadership Network, and leading the transition to community-based services at United Cerebral Palsy of King and Snohomish Counties (WA). She also worked at the University of Northern Colorado, Center for Technical Assistance and Training and served as the Executive Director of Support Services for Citizens with Autism, Inc.

**Karen Jackuback, M.A.**, is a Program Planner for the New York State Developmental Disabilities Planning Council (DDPC). Ms. Jackuback's experience is in planning, developing, implementing and evaluating DDPC related initiatives and activities. She provides programmatic oversight of the Project SEARCH™ and Think College NY! Post-secondary grants with the University of Rochester Strong Center for Developmental Disabilities, as well as other DDPC funded initiatives.

**Fran Judge, RN**, is Assistance Medical Director for UCP of New York City (NYC). She entered the work world as a business woman and fulfilled her lifelong dream to become a registered nurse in 1975. Fran came to work at United Cerebral Palsy in 1997 after her grandson was born and was diagnosed with cerebral palsy. Ms. Judge worked as a program nurse, Clinic Administrator, Residential Nursing Supervisor, Director of Clinical Services for the Residential Division, and Director of Operations for Nursing and therapeutic Services. In 2005, Fran was appointed to the Surrogate Decision Making Committee of New York State Commission of Quality of Care and Advocacy for Persons with Disabilities. Since 2003, Fran co-chaired the Health and Clinical Services Committee of the Executive Board of the Staten Island Council, is Chair of the Morbidity and Mortality Committee for UCP of NYC, and a member of the advisory board of the Kingsborough Community College since 1998. She has been a member of the MRDD Nurse Association and the national DD nurses Association since entering the field. Fran is co-author of the HealthLink for Nurses curriculum.

**Irene Jurczyk, BBA**, is associate director of continuing medical education for the North Carolina Council on Developmental Disabilities grantee, Mountain Area Health Education Center (MAHEC). In 2003, MAHEC responded to a Request for Applications from the NCCDD to improve quality and access to primary care services for persons with Intellectual and Developmental Disabilities culminating in the creation of the nation's first mini-fellowship in adult developmental medicine in 2007, under the medical direction of Bruce Kelly, MD, Black Mountain Neurosciences Center.

**Kathy Kelly, RN**, is Assistant Medical Director at United Cerebral Palsy of New York City and is the co-author of HealthLink for Nurses. Ms. Kelly has an extensive clinical background in acute and ambulatory health care. Kathy's background in ambulatory health care enabled her as Director of Clinical Services at UCP of NYC to begin the development of health care services at the agency and today has expanded to serve over 6,000 individuals with disabilities though out New York City in their four health care clinic facilities. Through Kathy's leadership UCP of NYC opened the first

Augmentative Communication Center in NYC that served person with disabilities who have Medicaid only. The center remains a model today for the disability community. In 2005 she was appointed to the governor's task force to revise the Medicaid system in order to improve access to durable medical equipment for person with disabilities. She remains on the Alumni Board of Directors for the Phillips Beth Israel School of Nursing. She is currently the Assistant Medical Director at United Cerebral Palsy of New York City and is the co-author of HealthLink for Nurses.

**William Kiernan, Ph.D.** is the director of the Institute for Community Inclusion and a research professor in the Graduate College of Education and the McCormack School of Policy Studies at the University of Massachusetts Boston. He has served in a variety of capacities at ICI for 30 years at Children's Hospital Boston, and has been a university faculty member for over two decades. Dr. Kiernan has broad experience developing and implementing training and model demonstration projects in integrated employment, inclusive education, recreation, transition, and systems change. He has worked extensively with the public and private employment and training systems at the state and national levels. He has served as an international consultant in seven countries and provided training and technical assistance in more than 45 states. Dr. Kiernan holds several national offices in professional and advocacy groups, including current president of the Association of University Centers on Disabilities (AUCD) and past president of the American Association on Mental Retardation (now the American Association on Intellectual and Developmental Disabilities). He is the author of six books and more than 125 articles and reports, emphasizing employment and public policy development in adult services, and is considered a national expert on the subject.

**John Kramer** is co-founder and leader of the Sibling Leadership Network (SLN) in the United States; currently he is the Chairperson of the SLN. John also co-founded the Illinois and Massachusetts state sibling chapters. John is working with the research team at the Institute on Community Inclusion at the University of Massachusetts at Boston on systems change and employment issues for people with disabilities. He received a PhD in Disability Studies from the University of Illinois at Chicago, with his dissertation research focusing on the transition of support from parents to siblings and the support siblings provide each other as they grow older.

**Bill Krebs** serves on the Governors Cabinet and Advisory Committee for People with Disabilities, Independent Monitoring for Quality Steering Committee, Sexual Predators and Victims Committee, Planning Advisory Committee (PAC), the Statewide Report Card, and the Cultures Confidence Committee. He is a former Board member of St. Johns, Visions for Equality, COMHAR, Quality Progressive Supports, Speaking for Ourselves, and Chester County MH/MR Board. Mr. Krebs also served on the Philadelphia Mayor's Committee on Disabilities, the Philadelphia Public Awareness Committee, and the CMS Waiver Rewriting Committee.

**Sharon Lewis** was appointed Commissioner of the Administration on Developmental Disabilities in March 2010. Prior to her appointment as Commissioner, she served as the Senior Disability Policy Advisor to U.S. House Committee on Education & Labor, advising members of the Committee on legislative strategy and disability-related policy issues in education, employment and healthcare, and as a Kennedy Public Policy Fellow for U.S. Senate Subcommittee on Children & Families. Sharon is the recipient of numerous awards, including the 2010 Distinguished Leadership in National Disability Policy Award and the Consortium for Citizens with Disabilities Chairman's Award. In Oregon, Sharon worked on public policy for the Oregon Developmental Disabilities Coalition and for the Arc. She served as the co-chair of the Oregon Family Action Coalition Team, founded

DisabilityCompass.org and managed the Oregon Partners in Policymaking Program, working with individuals with disabilities and family members to participate in policy decisions at all levels. Sharon is a parent to three daughters, including one with disability. She is a native of Michigan and a graduate of Washington University in St. Louis.

**Anna Lobosco, Ph.D.** is a Developmental Disabilities Program Developmental Specialist IV and Deputy Executive Director of the NYS DDPC. Current responsibilities include oversight of accountability and innovative program development as well as assistance and support to the agency staff and Council members. Her academic preparation includes a Ph.D. in Education, with a specialization in program development and evaluation from the University at Albany; a Master of Education in Special Education from the College of St. Rose; and a B.A. in History from Marist College. Dr. Lobosco has worked for the NYS DDPC since 1989 in the developmental disabilities field since 1974; she has also designed and taught undergraduate and graduate level courses in developmental disabilities related topics as adjunct faculty. Before coming to the DDPC, Dr. Lobosco worked in early intervention, special education, teacher training, and program evaluation.

**Alison Lozano, Ph.D., M.P.A.** is the Executive Director for the New Jersey Council on Developmental Disabilities. Prior to coming to New Jersey, she was the Executive Director of the Utah Developmental Disabilities Council. Dr. Lozano also served as the Director of Social Work at the Boling Center for Developmental Disabilities in Memphis Tennessee and as a Genetic Social Worker at both the University of Tennessee and at the Texas Department of MHMR. She also taught at the University of Utah. Dr. Lozano has extensive experience in supporting children and adults with developmental disabilities. She obtained her Ph. D. in Social Work and Master's in Public Administration from the University of Utah, where her dissertation studied resources for parents with developmental disabilities. She is the parent of an adult with developmental disabilities who lives in a supported apartment.

**Angela Martin** is a Community Support Specialist/Research Assistant with the Developmental Disabilities Institute at Wayne State University (Michigan's University Center for Excellence in Developmental Disabilities) in Detroit, Michigan. Angela has a Master's degree in Social Work with a concentration in Community Practice and Social Action. She has experience in family support resource development and curriculum design and training on Self-Determination, Person Centered Planning, and Leadership/Self-Advocacy. She is currently serving as the Project Coordinator for Michigan Partners for Freedom. As the sibling of a young woman who has a developmental disability, Angela has the unique personal perspective of assisting her sister in arranging supports based on the principles of Self-Determination.

**Kathleen Martinez** was nominated by President Barack Obama to be the third Assistant Secretary for Disability Employment Policy and was confirmed by the U.S. Senate on June 25, 2009. As head of the U.S. Department of Labor's Office of Disability Employment Policy (ODEP), Ms. Martinez advises the Secretary of Labor and works with all DOL agencies to lead a comprehensive and coordinated national policy regarding the employment of people with disabilities. Blind since birth, Ms. Martinez comes to ODEP with a background as an internationally recognized disability rights leader specializing in employment, asset building, independent living, international development, diversity and gender issues. She was appointed Executive Director of the World Institute on Disability (WID), based in Oakland, California, in 2005. Ms. Martinez directed Proyecto Visión, WID's National Technical Assistance Center to increase employment opportunities for Latinos with disabilities in

the United States, and Access to Assets, an asset-building project to help reduce poverty among people with disabilities. At WID, she also led the team that produced the acclaimed international webzine DisabilityWorld ([www.disabilityworld.org](http://www.disabilityworld.org)) in English and Spanish. In 2007 she was appointed a member of the board of the U.S. Institute of Peace, a Congressionally-created agency dedicated to research and projects in conflict management. In 2005 Secretary of State Condoleezza Rice appointed her as one of eight public members of the newly-established State Department advisory committee on disability and foreign policy. In 2002 she was appointed by President Bush as one of 15 members of the National Council on Disability, an independent federal agency advising the President and Congress on disability policy.

**Mathew McCollough** is Executive Director of the District of Columbia Developmental Disabilities Council. Most recently, Mr. McCollough was appointed by President Barack Obama to serve on the U.S. Access Board, an independent Federal agency devoted to accessibility for people with disabilities. Previously, he served as the Communications Manager for the Office for Disability Rights, the Americans with Disabilities Act (ADA) compliance office for the DC Government. Matt has served in both the federal and not-for-profit sectors and has spent the majority of his professional career ensuring meaningful and productive opportunities for people with and without disabilities in their communities. He is recognized for his communication and training expertise in the areas of education, diversity and sensitivity, cultural competency, and disability issues to a broad spectrum of audiences - students, advocates, parents, managers, community leaders, and other stakeholders. Prior to the Office of Disability Rights, he served as a grants manager and trainer for the Association of University Centers on Disabilities and the National Service Inclusion Project - a training and technical assistance provider that advocates on the behalf of individuals with disabilities to fully participate in service and civic-minded programs within their communities. Mr. McCollough received his master's degree in Public Administration from American University and his bachelor's degree in political science from James Madison University.

**Elise McMillan, J.D.** is the Faculty Co-Director of Next Steps, Director of Community Outreach for the Vanderbilt Kennedy Center for Research on Human Development and Co-Director of the Vanderbilt Kennedy University Center for Excellence in Developmental Disabilities Education, Research, and Service (UCEDD). She is a Senior Associate in the Department of Psychiatry and Senior Lecturer in Special Education. She is a leader of the Tennessee Task Force for Postsecondary for Students with Intellectual Disabilities. She is a board member of The Arc of the US, Tennessee Disability Coalition, Tennessee Council on Developmental Disabilities, Mayor's Advisory Council on Special Education, and the Disability Law and Advocacy Center of Tennessee. She and her husband Tom are the parents of three children, including a son with Down Syndrome.

**Stacey Milbern** is the Community Outreach Director of the National Youth Leadership Network and has been a youth organizer since high school. She recently moved out of her parent's home in North Carolina to the San Francisco Bay Area. She has been documenting the journey of building an interdependent home in an epistolary blog titled "To the Other Side of Dreaming". She served on the North Carolina Statewide Independent Living Council for four years and is excited to get involved in the California disability community.

**Martha Mock, Ph.D.**, is the Director of the Institute for Innovative Transition (IIT) based at the University of Rochester Strong Center for Developmental Disabilities (a UCEDD). Dr. Mock has over 20 years experience working alongside people with disabilities and their families, teaching at the public school and university level, and administering local, state and federal grants in both New

York and Wisconsin. The IIT currently partners with the New York State Developmental Disabilities Planning Council to implement two innovative programs: Project SEARCH™ and Think College NY!

**David Morrissey** is a leader in the nonprofit sector and has advanced missions of HIV/AIDS care and prevention, disability and independent living, and community volunteerism. He now leads US International Council on Disabilities on its Global Disability Rights Library Project and Education and Advocacy Program on the Convention on the Rights of Persons with Disabilities.

**Graham Mulholland** is Executive Director of the Pennsylvania Developmental Disabilities Council. Previously, he provided management and planning for a multi-state group of nonprofit agencies. His academic background is in epistemology and applied social science, and he has been particularly involved in Council work around quality and outcomes. He is one of the authors of the Route to Success model of evaluating systems change. Graham enjoys an unhealthy lifestyle in New Cumberland PA and spending time with his two adult daughters.

**Dr. Melody Musgrove** was selected by the White House to be Director of the Office of Special Education Programs (OSEP) for the U.S. Department of Education, and assumed the role in August of 2010. Dr. Musgrove grew up in Mississippi, the child of public school teachers. She worked as a classroom teacher, school administrator, district special education director and assistant superintendent before becoming State Director of Special Education for the Mississippi Department of Education, where she served until January 2007. From 2007 until 2010, she was Director of Business Development for LRP Publications, the nation's leading publisher of legal and regulatory guidance for educators. Dr. Musgrove's career is distinguished by her commitment to collaborative frameworks that find creative solutions to difficult educational problems. She is focused on improving outcomes for all children, and experienced in using data to influence systemic improvement decisions. During her tenure as State Director of Special Education, students with disabilities achieved improved results in reading and math, schools implemented more inclusive practices, graduation rates increased, and drastic steps were taken to halt disproportionate identification of African-American students for special education. Dr. Musgrove and her husband, Ronnie, have four children ranging in age from 23 to 28, all of whom graduated from Mississippi public schools, and one grandchild born in November 2010. The Musgrove family also includes a rescued shelter dog named Noah. They divide their time between homes in Madison, Mississippi and Washington, DC.

**Don Meyer** is a Board member of the Sibling Leadership Network as well as the director of the Sibling Support Project. Don is probably best known for creating Sibshops, lively programs just for young brothers and sisters of kids with special needs. Currently, there are over 200 Sibshops in eight countries. Don also created SibKids and SibNet, no-cost listservs for young and adult brothers and sisters which allow hundreds of siblings from around the world to connect with their peers. He was a founder of the SEFAM (Supporting Extended Family Members) program at the University of Washington, which pioneered services for fathers, siblings, and grandparents of children with special needs. As a sought-after speaker, Don has conducted hundreds of workshops on siblings, fathers, and grandparents of children with special needs and trainings on the Sibshop model throughout the United States, Canada, Ireland, Iceland, England, Italy, New Zealand, and Japan. Mr. Meyer is senior author or editor of six books.

**Jessica S. Oppenheim, Esq.** joined the Arc of New Jersey as Director of the Developmentally Disabled Offenders Program in June 2010 where she provides support and assistance to criminal

offenders who have developmental and intellectual disabilities and are seeking alternatives to incarceration. She provides training to case managers, law enforcement and members of the state bar in understanding and working with individuals who have intellectual and developmental disabilities. She is on the Board of the Association for the Treatment of Sexual Abusers, the NJ State Bar Association, developmental disabilities rights section, the Middlesex County Bar Association and is on the Board of Women Aware, the Middlesex County service provider for survivors of family violence. Jessica has a distinguished record working as a Deputy Attorney General, Bureau Chief of the Prosecutors Supervision and Coordination Bureau in the Division of Criminal Justice, counsel to the State Office of Victim-Witness Advocacy and the State Medical Examiner's Office. She represented the Attorney General on the Task Force Against Child Abuse and Neglect, the Governor's Council on Domestic Violence, the Regional Diagnostic Center Advisory Council, and the Sexually Violent Predator Advisory Council. Ms. Oppenheimer has provided extensive training to law enforcement, state, county and local agencies and community organizations in the areas of Megan's Law and domestic violence. She has provided training in the area of internal affairs for law enforcement agencies and is a certified Police Training Commission instructor. Jessica is an adjunct professor in the criminal justice studies department of Fairleigh Dickinson University.

**James O'Neill** became a self-advocate because he was tired of the bullying he received as a kid at school. James is known state-wide for his self-advocacy presentations. He is on the board of the Utah Developmental Disabilities Council and the Disability Law Center. He is the historian of the Park City People First (PCPF) Chapter and is currently the Outreach Facilitator and Chapter blogger for the PCPF group. He lives in Park City, works at Albertsons, and thinks that being a self-advocate is a very important job.

**Laura Owens, Ph.D.** is the Executive Director of APSE (formerly the Association for Persons in Supported Employment), a national association focusing on the advancement of integrated employment for citizens with disabilities based Washington, DC. She is also an Associate Professor at the University of Wisconsin-Milwaukee in the Department of Exceptional Education and the Director/Founder of Creative Employment Opportunities, Inc. (CEO), an employment agency for individuals with disabilities in Milwaukee, Wisconsin. Laura is an internationally recognized speaker and has presented at the European Union on Supported Employment in Ireland (2007) and in the Czech Republic (2009). Fundamental to her work is helping society at large see beyond the "current reality" to what can be, and not to set limits on themselves or individuals with diverse abilities. Laura earned her M.S. degree in special education from the University of Wisconsin - Milwaukee and her Ph.D. from the University of Wisconsin - Madison.

**Jeff Parker** currently serves as the Chairperson of the Pennsylvania Developmental Disability Council (PADDC) and has been proud to support Council efforts to promote cultural competence, systems change and generic change in order to create a Commonwealth where all persons with disabilities are valued and thrive. In his similar role as President of the Board of Directors of The Three Rivers Community Foundation (TRCF), Jeff assists Foundation efforts to support social change by funding and encouraging activism among grassroots organizations in southwestern Pennsylvania to bridge divisions in society on issues of race, economic status, gender, sexual orientation and disability. Parker is currently employed as the Chief Operating Officer at UCP/CLASS. This organization is the fourth-largest nonprofit human service agency in Southwestern Pennsylvania, has approximately 350 employees and provides services for over 4,000 persons and families with disabilities. Jeff has found that his work at UCP/CLASS

complements his commitment to the PADDCC and the TRCF with its mission to empower people, create communities while working toward a community where each belongs.

**Christine Pisani** has been a Program Specialist with the Idaho Council for 15 years, 10 of which has been spent helping to grow a statewide self-advocacy organization for Idaho. In addition to her commitment to self-advocacy, Christine has also worked on issues related to voting, alternatives to guardianship, abuse and neglect, employment, self-direction, Medicaid policy, and coordination of Partners in Policymaking.

**Carol Risley** is Executive Director for California State Council on Developmental Disabilities. In her role she spearheads statewide public policy education, legislation and advocacy for persons with disabilities. Previously, Carol was the Chief, Office of Human Rights for California Department of Developmental Services ensuring rights and equality for over 250,000 people served and 7,000 employees.

**Lynnae M. Ruttledge** is the Commissioner of the Rehabilitation Services Administration, following Senate confirmation and Presidential appointment in late 2009. As a person with a disability and a former consumer of state vocational rehabilitation services, she brings a valued perspective to the work of RSA and OSERS. As Commissioner, Lynnae provides national level leadership and serves as a catalyst for positive change at the federal level to increase the employment of individuals with significant disabilities. With more than 20 years of leadership in the public vocational rehabilitation program, Lynnae has committed her career to public service. She served as the Director of the Washington Division of Vocational Rehabilitation from 2005-2009 and served in executive level leadership positions with the Oregon Office of Vocational Rehabilitation Services starting in 1987.

**Lynette Savoy** is the Vice President of the Board Directors of Speaking for Ourselves, a member of the Planning Advisory Committee (PAC) and a member of the Partners in Policy training program offered by the Temple University Institute on Disabilities. She is the former Co-Chair of the Public Awareness Committee of Philadelphia MH/MR office and Board Member of Disability Rights Network.

**Mandy Shale, M.Ed.** is the Executive Director and Founder of Family Advocacy and Consultation Services, Inc., a social services agency located in northern Utah that provides services to individuals with cognitive, developmental, physical, and mental health disabilities, to brain injury survivors, and those who support them. Mandy has over sixteen years of experience supporting individuals with developmental disabilities and their families in varying capacities including as a waiver case manager, special educator, support staff, behavior specialist, tutor, and advocate. Mandy is a fierce advocate and is both excited and proud to be a part of the Grassroots Advocacy Partnership and People First advocacy groups in Utah. Ms. Shale resides in Ogden, Utah with her husband and son.

**Mark Starford** is affiliated with the Board Resource Center (BRC) and partners with state and U.S. agencies to develop plain language materials that support people with disabilities and limited literacy to foster self-determination, career development and involvement in public policy. Active in teaching, training and advocacy for over 30 years, BRC has produced training with adapted curricula and digital tools used across the country and offers a comprehensive library of accessible media that make complex ideas easier to access and apply ([www.brcenter.org](http://www.brcenter.org)).

**Beth Swede** is Executive Director of the Wisconsin Board for People with Developmental Disabilities and has worked extensively on statewide disability-related outreach programs, research, and evaluation with emphasis on early intervention, parent and youth leadership, community inclusion and participation, self-advocacy, and youth transition issues. She has contributed to more than 20 journal articles and multiple outreach publications for both research and practitioner communities, as well as presented widely at state and national conferences. She is the parent of two young adult daughters, one of whom has a developmental disability.

**Ricardo Thornton** works in a bookworm's natural habitat. A library technician at the Martin Luther King, Jr. Memorial Library in Washington, D.C., he spends his days among books. Whether fiction or non-fiction, paperback or hardback, bestseller or literary unknown, chances are they have passed through Ricardo's hands. Ricardo's main responsibilities include sorting, stamping and shelving books and other clerical duties. He likes working both independently and as part of the library's larger team, and takes great pride in ensuring that patrons are satisfied with the branch's service and collection. "If the public is happy, we're happy," he says with a smile. Ricardo's success discredits common misconceptions about the skills of people with intellectual disabilities. He began by volunteering at the library as a young person 32 years ago, as part of a special education program. Ricardo enjoyed the experience and, working with a job coach, eventually gained the skills necessary to become a full-time paid employee. Even today, he continually seeks to expand his abilities; he is currently working on improving his computer skills. Like a lot of library personnel, Ricardo himself loves to read, but doesn't have the time to do so as often as he'd like. Off the clock, he is an active advocate for people with intellectual disabilities, speaking about his experiences and serving as a role model, especially for young people. His message is, "If I can make it, so can you. Give it your best and the rest will follow. If you do that, you'll see yourself growing and growing every day." An athlete and ambassador with Special Olympics, Ricardo has travelled as far as South Africa and Morocco. Closer to home, he has been an honored guest at the White House, where he and his family met former President Clinton. In addition to dedicated employee and advocate, Ricardo holds two other important positions — those of husband and father.

**Liz Weintraub** works for the Association of University Centers on Disabilities and the Council on Quality & Leadership (CQL) as well as consulting for the National Children's Center in Washington, DC. She has a long history of leadership in self advocacy, and has held many board and advisory positions at state and national organizations. Liz is the immediate past chair of the Maryland Developmental Disabilities Council, a faculty member of The National Leadership Consortium on Developmental Disabilities at the University of Delaware, and President of the Board of Directors for Shared Support Maryland, a progressive provider organization.

**Wanda Willis** has been the Executive Director of the Tennessee Council on Developmental Disabilities since 1991. In that capacity, she has spearheaded Council systems change initiatives in housing, employment, child care and other areas, launched the Tennessee Partners in Policymaking Leadership Institute and the Tennessee home-of-your-own initiative for individuals with developmental disabilities. Previously, Wanda was Director of Planning for the State Division of Mental Retardation Services (1986-1991), an administrator for community mental retardation services in Tennessee (1977-1986), a school psychologist, and classroom teacher in South Carolina (1971-1977).

**Brooke Wilson** serves as Outreach Coordinator for the Grassroots Advocacy Partnership and has over seven years in the nonprofit field including co-founding Marbles for Miracles a local nonprofit formed to help families affected by autism. Brooke has developed many relationships within the disability community through serving on multiple committees including the Family Links Planning Committee for the Utah Parent Center and the Autism Council of Utah. She is also a member and active participant of Family to Family Network, LCPD, Autism Coalition of Utah and Park City People First. Brooke resides in Midway, Utah with her husband Corey and their four children.

# Exhibitors

## **AAIDD**

[www.aaidd.org](http://www.aaidd.org)

Since 1876, the American Association on Intellectual and Developmental Disabilities (AAIDD) has been providing worldwide leadership in the field of intellectual and developmental disabilities. AAIDD promotes progressive policies, sound research, effective practices, and universal human rights for people with intellectual and developmental disabilities. Our goals are to enhance the capacity of professionals who work with individuals with intellectual and developmental disabilities, participate in the development of a society that fully includes individuals with intellectual and developmental disabilities, and build an effective, responsive, well managed, responsibly-governed, and sustainable organization.

## **DK Arts**

[www.dylankarts.com](http://www.dylankarts.com)

Dylan Kuehl, 28, self-advocate and international winning artist and poet from Olympia, Washington, owns his own visual and performing arts company (est. 2005). He sells his art on postcards, greeting cards, magnets, necklaces and most recently started working with fused glass. Dylan spreads hope and possibility for others to be encouraged to reach for their dreams. Stop by his booth and be inspired!

## **Elsevier DirectCourse/College of Direct Support**

[www.directcourseonline.com](http://www.directcourseonline.com) - Contact Information: Bill Waibel; Email: [b.waibel@elsevier.com](mailto:b.waibel@elsevier.com)

DirectCourse is a suite of online curricula, including the College of Direct Support and the new College of Employment Services. It's designed to educate, enrich and inspire professionals who support people with disabilities, and is a collaboration of the University of Minnesota, the Institute for Community Inclusion and Elsevier.

## **Essential Learning**

[www.EssentialLearning.com](http://www.EssentialLearning.com) - For more information: 800-729-9198 ext 212.

Essential Learning is one of the largest providers of e-learning services for the human service industry. Our courses are built from best field practices, such as the American Association of Intellectual and Developmental Disabilities (AAIDD) publications, the CQL | The Council on Quality and Leadership Personal Outcomes Measures<sup>®</sup> and Customized and Self Employment with Griffin-Hammis Associates. Essential Learning offers a flexible learning management system and multiple course libraries on developmental disabilities, mental health, safety compliance, supervision/management and more. Over 200 courses are accredited by the National Alliance of Direct Support Professionals (NADSP).

## **The Arc**

[www.thearc.org](http://www.thearc.org)

The Arc promotes and protects the human rights of people with intellectual and developmental disabilities and actively supports their full inclusion and participation in the community throughout their lifetimes. The Arc is the largest national community-based organization advocating for and serving people with intellectual and developmental disabilities and their families. We encompass all ages and all spectrums from autism, Down syndrome, Fragile X and various other developmental disabilities. With more than 140,000 members and more than 700 state and local chapters nationwide, we are on the front lines to ensure that people with intellectual and developmental disabilities and their families have the support they need to be members of the community.

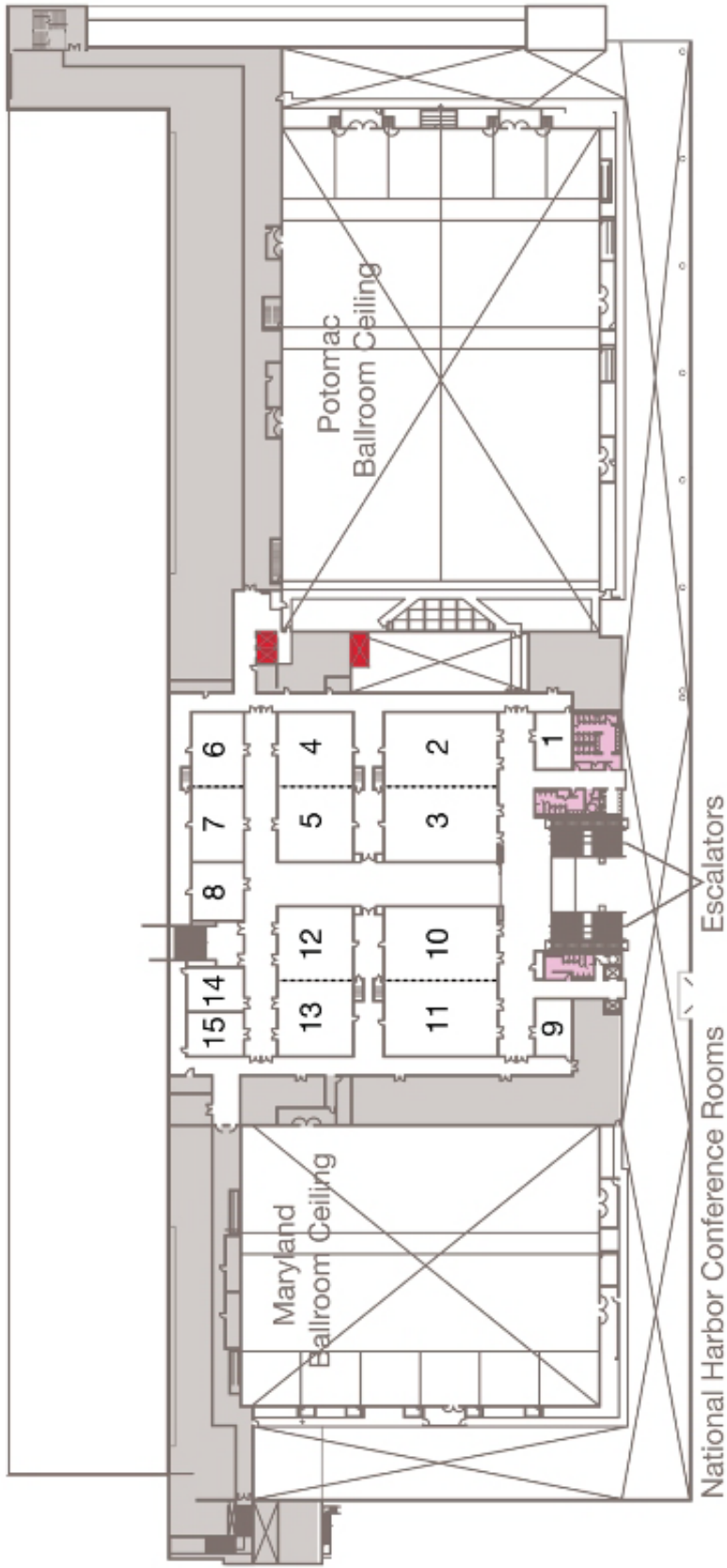







NACDD serves as the national voice of State and Territorial Councils on Developmental Disabilities. We support Councils in implementing the Developmental Disabilities Assistance and Bill of Rights Act and promoting the interests and rights of people with developmental disabilities and their families.

1825 K Street, NW, Suite 600  
Washington, DC 20006  
202.506.5813  
[www.nacdd.org](http://www.nacdd.org)